

G ELECTRICAL WIRING ROUTING

Position of Parts in Engine Compartment

[5VZ-FE]

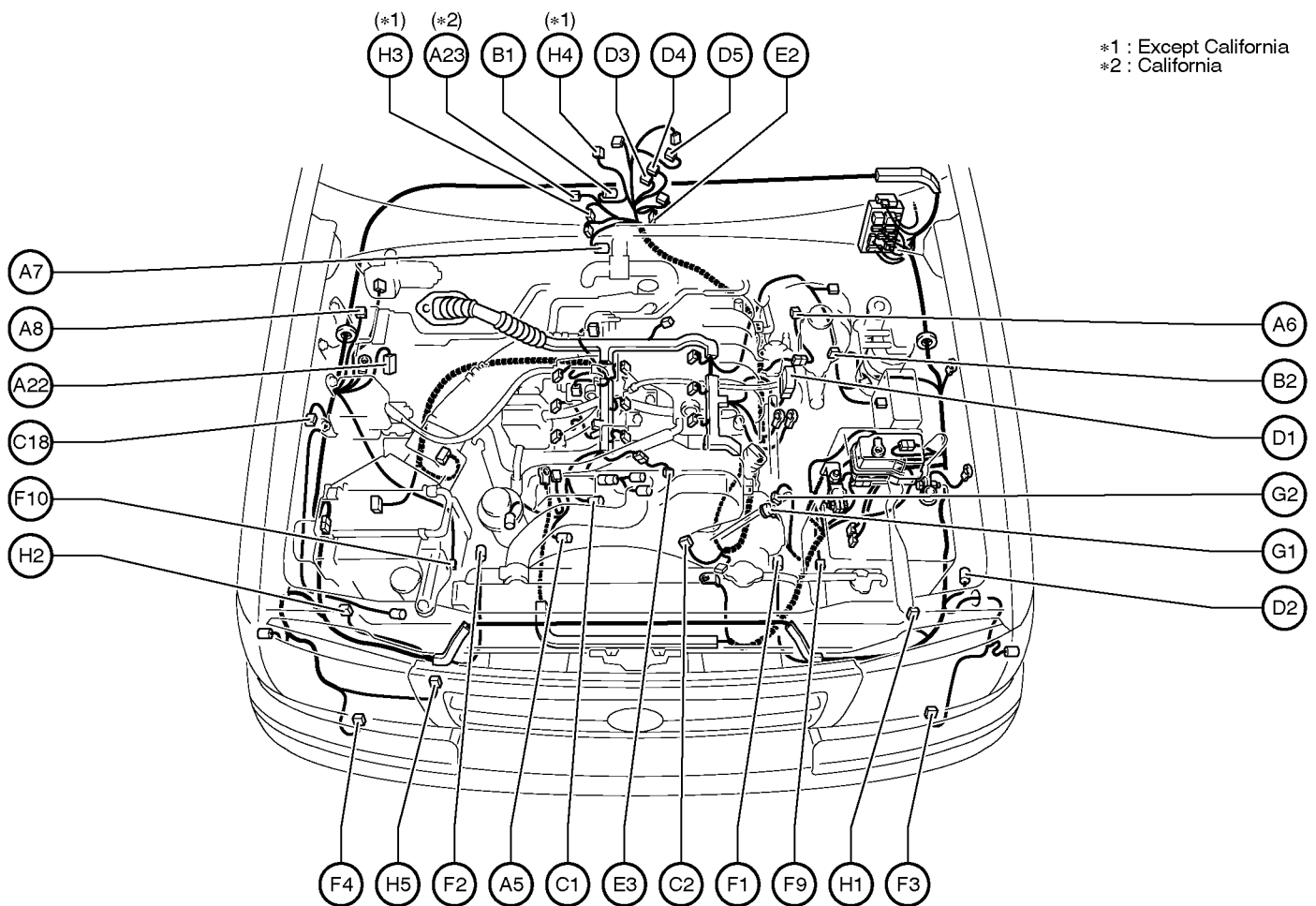

*1 : Except California
*2 : California

A 5 A/C Magnetic Clutch
A 6 ADD Indicator SW
A 7 A/T Oil Temp. Sensor
A 8 Auto Antenna Motor
A22 ABS Actuator with ECU
A23 Air Fuel Ratio Sensor (Bank 1 Sensor 1) (*2)

B 1 Back-Up Light SW
B 2 Brake Fluid Level Warning SW

C 1 Camshaft Position Sensor
C 2 Crankshaft Position Sensor
C18 Cruise Control Actuator with ECU

D 1 Data Link Connector 1
D 2 Daytime Running Light Resistor
D 3 Detection SW (Transfer L4 Position)
D 4 Detection SW (Transfer Neutral Position)
D 5 Detection SW (Transfer 4WD Position)

E 2 Electronically Controlled Transmission Solenoid
E 3 Engine Coolant Temp. Sensor

F 1 Front ABS Speed Sensor LH
F 2 Front ABS Speed Sensor RH
F 3 Front Turn Signal Light LH
F 4 Front Turn Signal Light RH
F 9 Front Airbag Sensor LH
F10 Front Airbag Sensor RH

G 1 Generator
G 2 Generator

H 1 Headlight LH
H 2 Headlight RH
H 3 Heated Oxygen Sensor (Bank 1 Sensor 1) (*1)
H 4 Heated Oxygen Sensor (Bank 1 Sensor 2) (*1)
H 5 Horn

Position of Parts in Engine Compartment

[5VZ-FE]

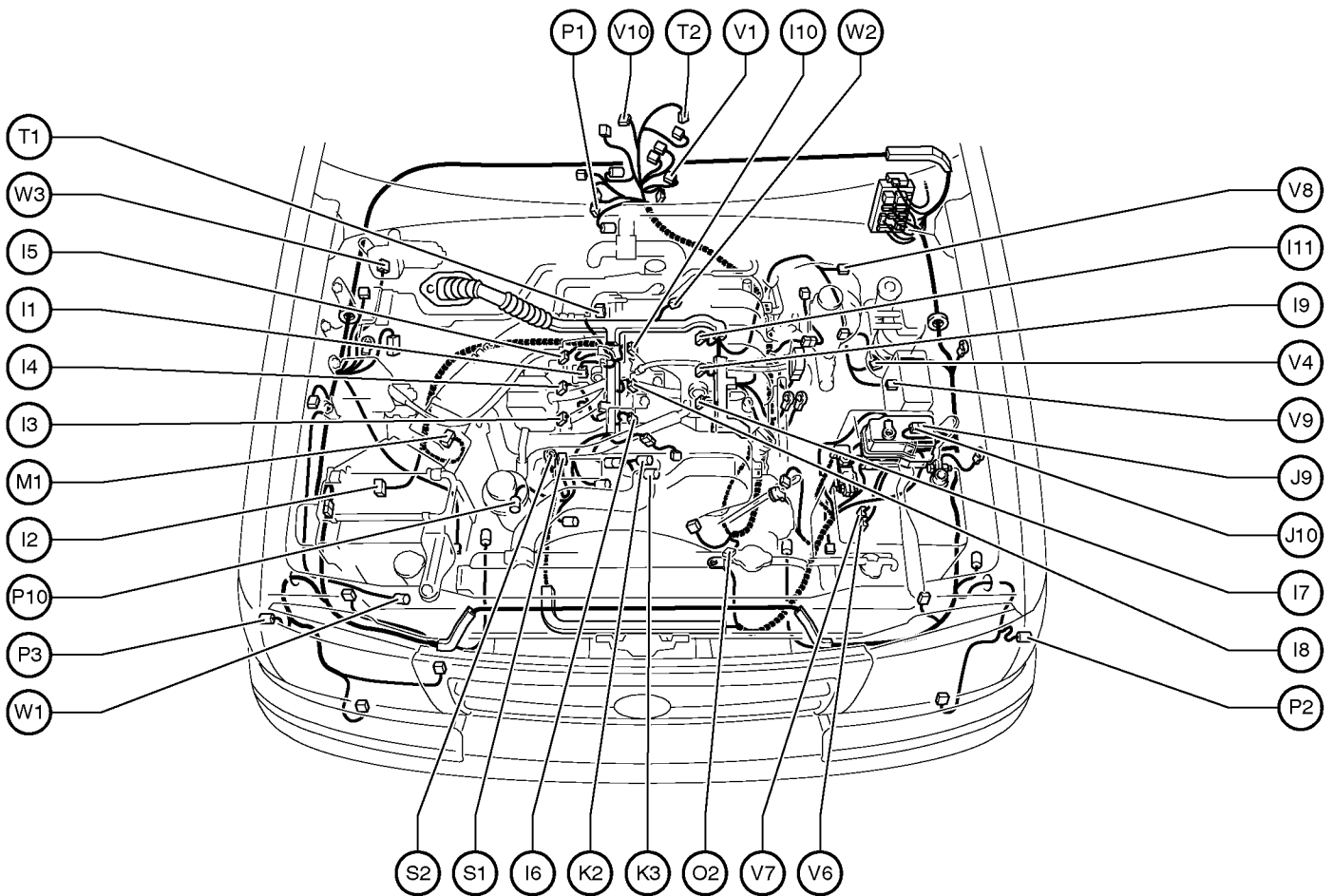

I 1 Idle Air Control Valve
 I 2 Igniter
 I 3 Ignition Coil No.1
 I 4 Ignition Coil No.2
 I 5 Ignition Coil No.3
 I 6 Injector No.1
 I 7 Injector No.2
 I 8 Injector No.3
 I 9 Injector No.4
 I 10 Injector No.5
 I 11 Injector No.6

J 9 Junction Connector
 J 10 Junction Connector

K 2 Knock Sensor 1
 K 3 Knock Sensor 2

M 1 Mass Air Flow Meter

O 2 Oil Pressure SW

P 1 Park/Neutral Position SW
 P 2 Parking Light LH
 P 3 Parking Light RH
 P10 Power Steering Oil Pressure SW

S 1 Starter
 S 2 Starter

T 1 Throttle Position Sensor
 T 2 2-4 Select Motor

V 1 Vehicle Speed Sensor
 (Electronically Controlled Transmission)
 V 4 VSV (EVAP)
 V 6 VSV 2(ADD)
 V 7 VSV 4(ADD)
 V 8 Vapor Pressure Sensor
 V 9 VSV (Vapor Pressure Sensor)
 V10 Vehicle Speed Sensor

W 1 Washer Motor (Except Cold Area Spec.) or Washer
 Motor and Washer Level Sensor (Cold Area Spec.)
 W 2 Water Temp. Sender
 W 3 Wiper Motor

G ELECTRICAL WIRING ROUTING

Position of Parts in Engine Compartment

[3RZ-FE, 2RZ-FE]

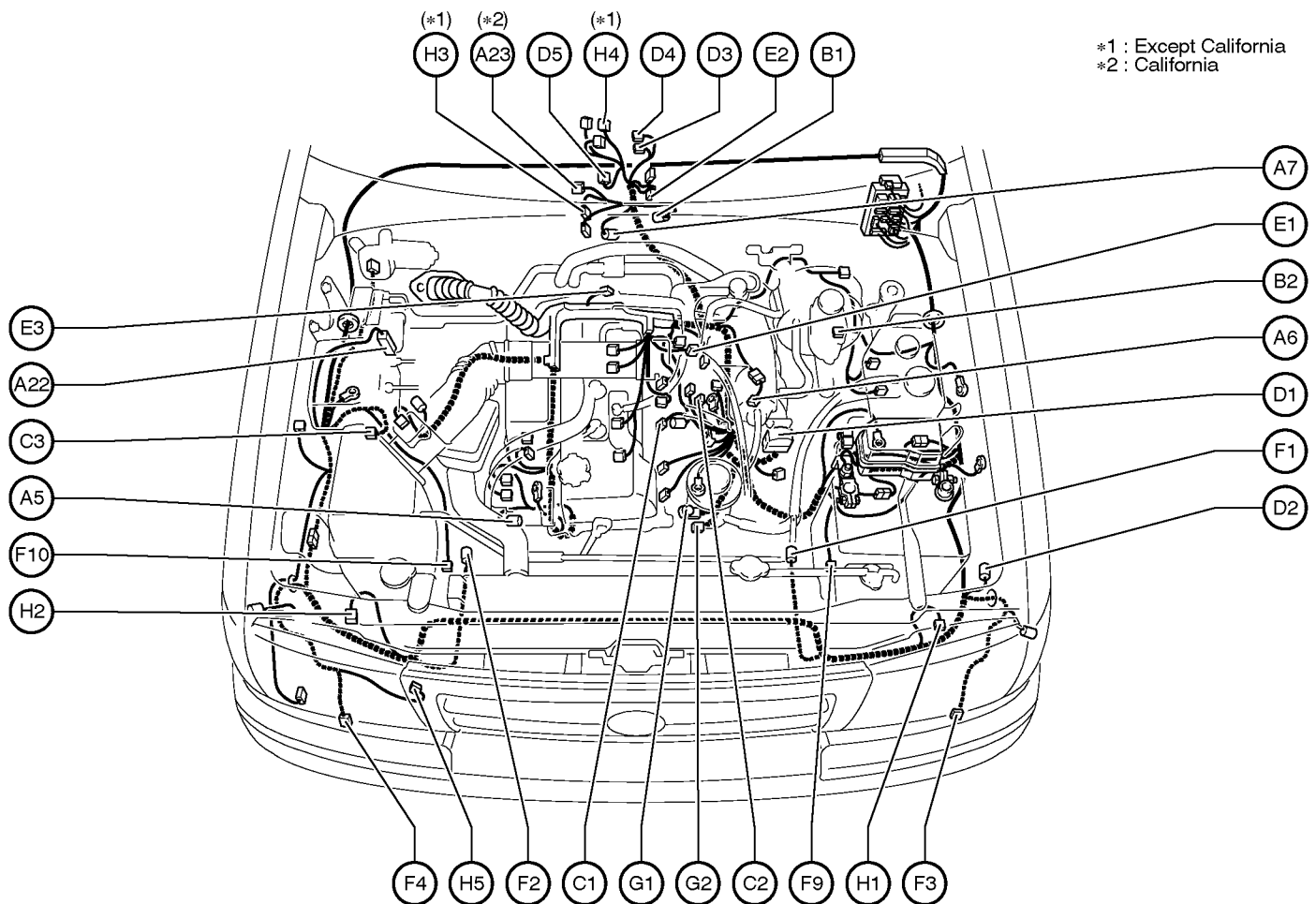

A 5 A/C Magnetic Clutch
A 6 ADD Indicator SW
A 7 A/T Oil Temp. Sensor
A22 ABS Actuator with ECU
A23 Air Fuel Ratio Sensor (Bank 1 Sensor 1) (*2)

B 1 Back-Up Light SW
B 2 Brake Fluid Level Warning SW

C 1 Camshaft Position Sensor
C 2 Crankshaft Position Sensor
C 3 Cruise Control Actuator

D 1 Data Link Connector 1
D 2 Daytime Running Light Resistor
D 3 Detection SW (Transfer L4 Position)
D 4 Detection SW (Transfer Neutral Position)
D 5 Detection SW (Transfer 4WD Position)

E 1 EGR Gas Temp. Sensor
E 2 Electronically Controlled Transmission Solenoid
E 3 Engine Coolant Temp. Sensor

F 1 Front ABS Speed Sensor LH
F 2 Front ABS Speed Sensor RH
F 3 Front Turn Signal Light LH
F 4 Front Turn Signal Light RH
F 9 Front Airbag Sensor LH
F10 Front Airbag Sensor RH

G 1 Generator
G 2 Generator

H 1 Headlight LH
H 2 Headlight RH
H 3 Heated Oxygen Sensor (Bank 1 Sensor 1) (*1)
H 4 Heated Oxygen Sensor (Bank 1 Sensor 2) (*1)
H 5 Horn

Position of Parts in Engine Compartment

[3RZ-FE, 2RZ-FE]

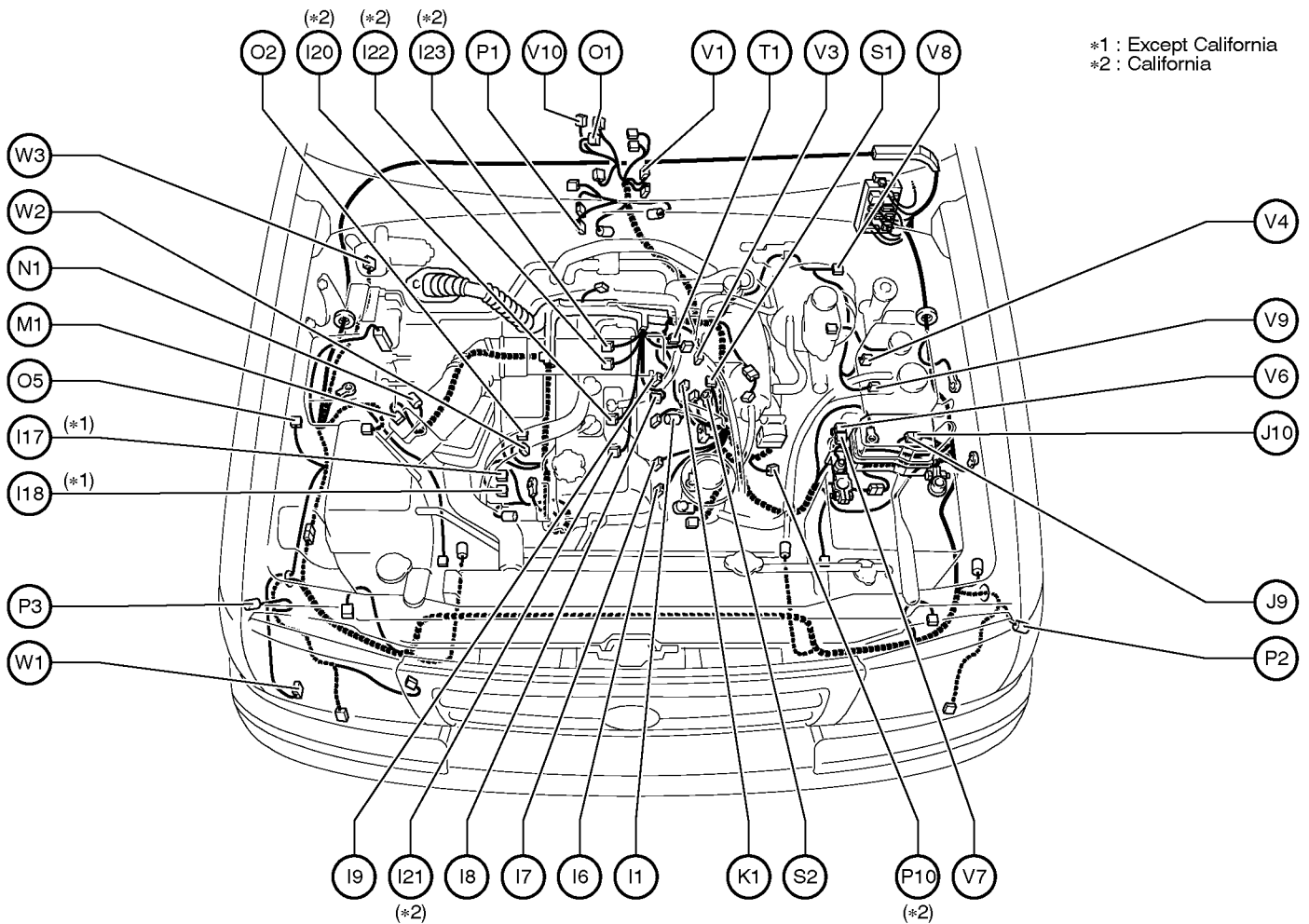

*1 : Except California
*2 : California

- I 1 Idle Air Control Valve
- I 6 Injector No.1
- I 7 Injector No.2
- I 8 Injector No.3
- I 9 Injector No.4
- I 17 Ignition Coil and Igniter No.1 (*1)
- I 18 Ignition Coil and Igniter No.2 (*1)
- I 20 Ignition Coil and Igniter No.1 (*2)
- I 21 Ignition Coil and Igniter No.2 (*2)
- I 22 Ignition Coil and Igniter No.3 (*2)
- I 23 Ignition Coil and Igniter No.4 (*2)

- J 9 Junction Connector
- J 10 Junction Connector

- K 1 Knock Sensor

- M 1 Mass Air Flow Meter

- N 1 Noise Filter (Ignition System)

- O 1 O/D Solenoid
- O 2 Oil Pressure SW
- O 5 O/D Cut Relay

- P 1 Park/Neutral Position SW
- P 2 Parking Light LH
- P 3 Parking Light RH
- P10 Power Steering Oil Pressure SW (*2)

- S 1 Starter
- S 2 Starter

- T 1 Throttle Position Sensor

- V 1 Vehicle Speed Sensor
(Electronically Controlled Transmission)
- V 3 VSV (EGR)
- V 4 VSV (EVAP)
- V 6 VSV 2(ADD)
- V 7 VSV 4(ADD)
- V 8 Vapor Pressure Sensor
- V 9 VSV (Vapor Pressure Sensor)
- V10 Vehicle Speed Sensor

- W 1 Washer Motor (Except Cold Area Spec.) or Washer
Motor and Washer Level Sensor (Cold Area Spec.)
- W 2 Water Temp. Sender
- W 3 Wiper Motor

G ELECTRICAL WIRING ROUTING

Position of Parts in Instrument Panel

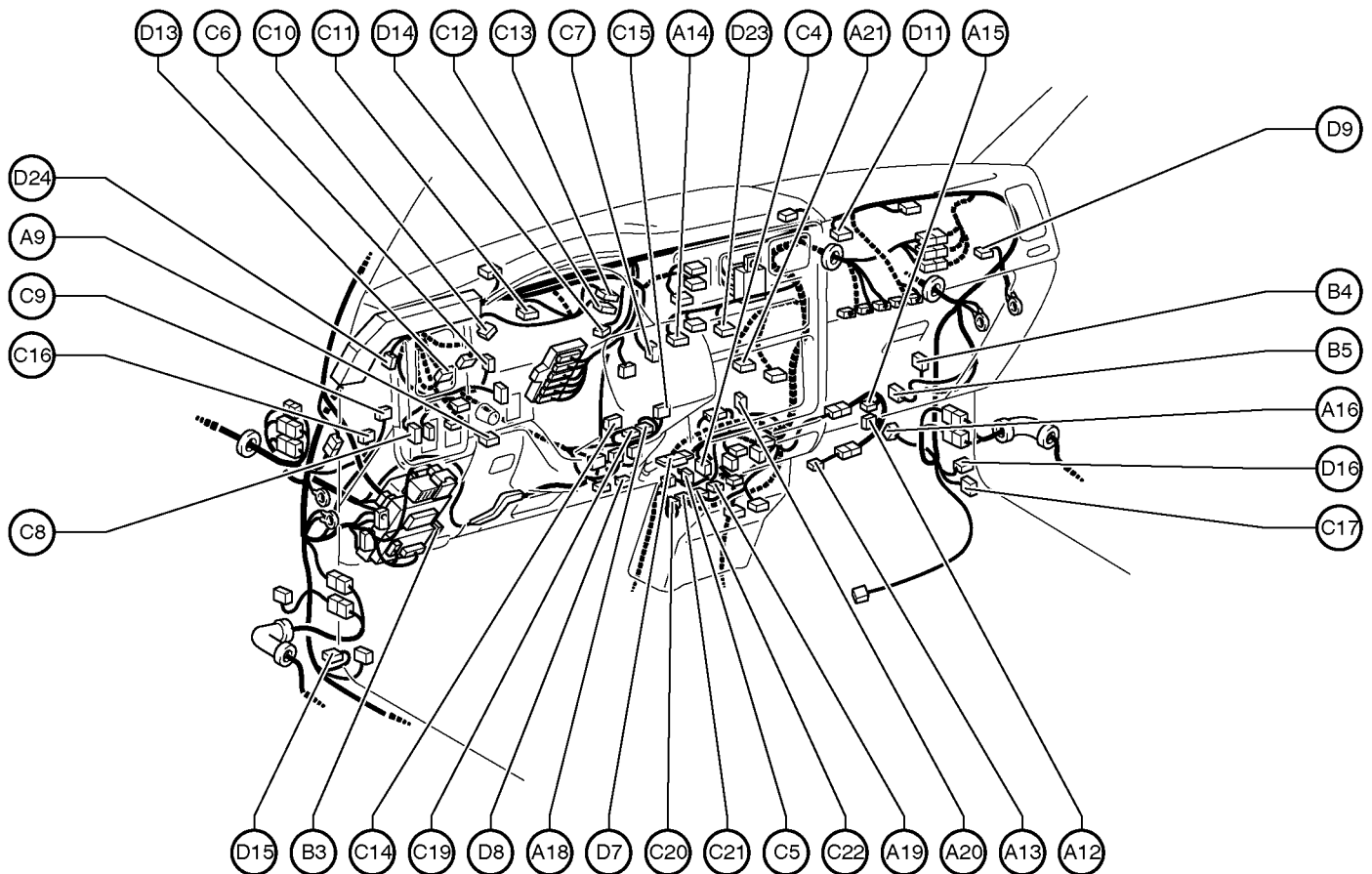

- | | |
|-----------------------------------------------------|------------------------------------------------|
| A 9 ABS Deceleration Sensor (4WD) | C 11 Combination Meter |
| A 12 A/C Amplifier | C 12 Combination Meter |
| A 13 A/C Dual Pressure SW | C 13 Combination Meter |
| A 14 A/C SW | C 14 Combination SW |
| A 15 A/C Thermistor | C 15 Combination SW |
| A 16 ADD Control Relay | C 16 Cruise Control Clutch SW |
| A 18 Airbag Squib (Steering Wheel Pad) | C 17 Cruise Control ECU |
| A 19 Ashtray Illumination | C 19 Combination SW |
| A 20 Auto Antenna Control Relay | C 20 Center Airbag Sensor Assembly |
| A 21 Airbag Squib (Front Passenger Airbag Assembly) | C 21 Center Airbag Sensor Assembly |
| | C 22 Center Airbag Sensor Assembly |
| B 3 Back-Up Light Relay | |
| B 4 Blower Motor | D 7 Data Link Connector 3 |
| B 5 Blower Resistor | D 8 Daytime Running Light Relay (Main) |
| C 4 Cigarette Lighter | D 9 Daytime Running Light Relay No.4 |
| C 5 Cigarette Lighter Illumination | D 11 Diode (O/D) |
| C 6 Circuit Opening Relay | D 13 Diode No.1 (Daytime Running Light System) |
| C 7 Clock | D 14 Diode No.2 (Daytime Running Light System) |
| C 8 Clutch Start Cancel SW | D 15 Door Courtesy SW LH |
| C 9 Clutch Start SW | D 16 Door Courtesy SW RH |
| C 10 Combination Meter | D 23 Defroster Mode SW |
| | D 24 Diode (Door Courtesy) |

Position of Parts in Instrument Panel

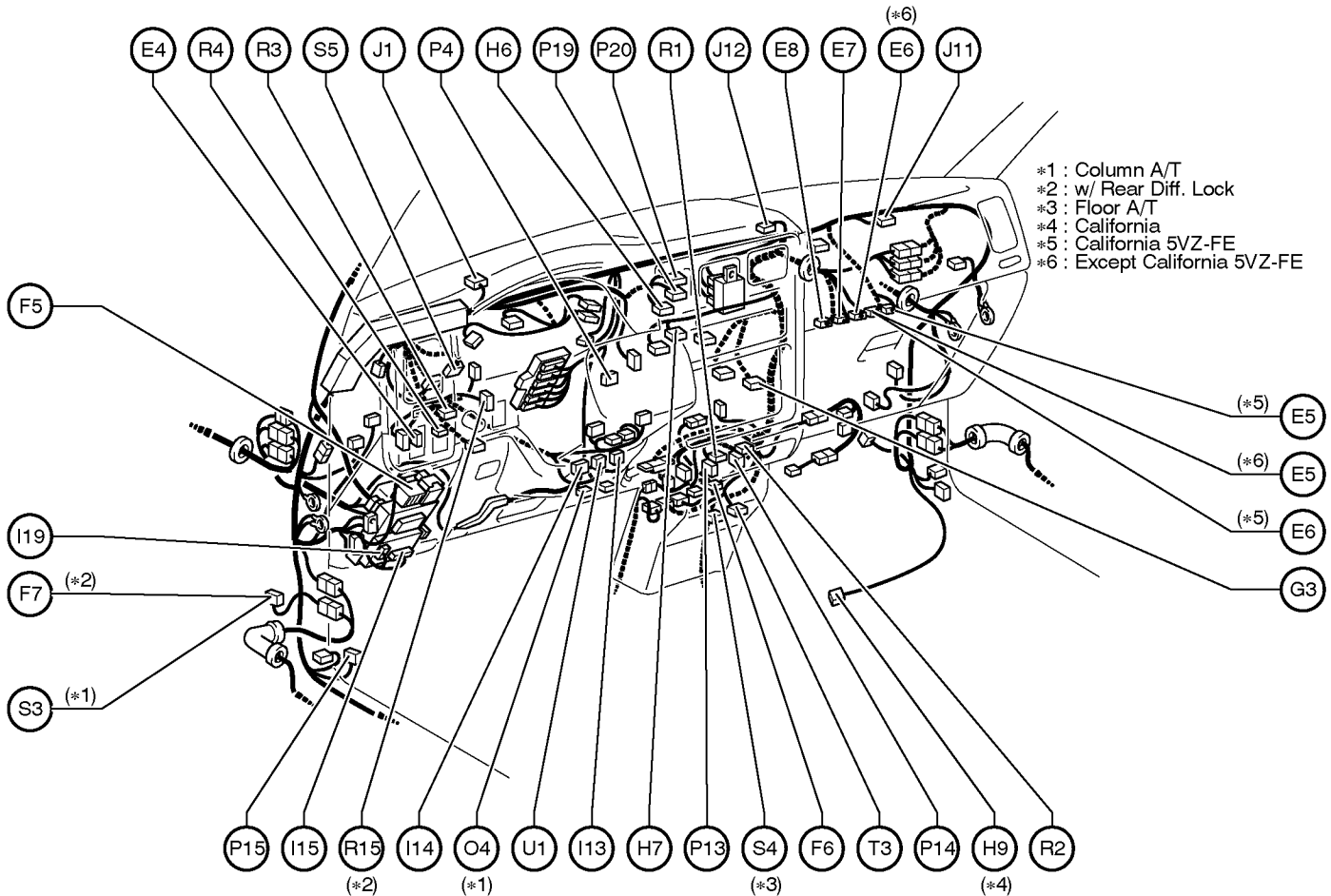

E 4 Electronically Controlled Transmission Pattern Select SW

E 5 Engine Control Module
 E 6 Engine Control Module
 E 7 Engine Control Module
 E 8 Engine Control Module

F 5 Fuse Box
 F 6 4WD ECU
 F 7 4WD Control ECU

G 3 Glove Box Light

H 6 Hazard SW
 H 7 Heater Blower SW
 H 9 Heated Oxygen Sensor (Bank 1 Sensor 2) (*4)

I 13 Ignition Key Cylinder Light
 I 14 Ignition SW
 I 15 Integration Relay
 I 19 Integration Relay

J 1 Junction Connector
 J 11 Junction Connector
 J 12 Junction Connector

O 4 O/D Main SW, Shift Lock Solenoid and Shift Lock Control SW

P 4 Parking Brake SW
 P 13 Power Outlet
 P 14 Power Outlet
 P 15 Power Window Main Relay
 P 19 Passenger Airbag Manual ON/OFF Indicator
 P 20 Passenger Airbag Manual ON/OFF SW

R 1 Radio and Player
 R 2 Radio and Player
 R 3 Rheostat
 R 4 Rheostat
 R 15 Rear Diff. Lock SW

S 3 Shift Lock Control Relay
 S 4 Shift Lock Control Relay and O/D Main SW
 S 5 Stop Light SW

T 3 2-4 Select SW

U 1 Unlock Warning SW and Key Interlock Solenoid

G ELECTRICAL WIRING ROUTING

Position of Parts in Body

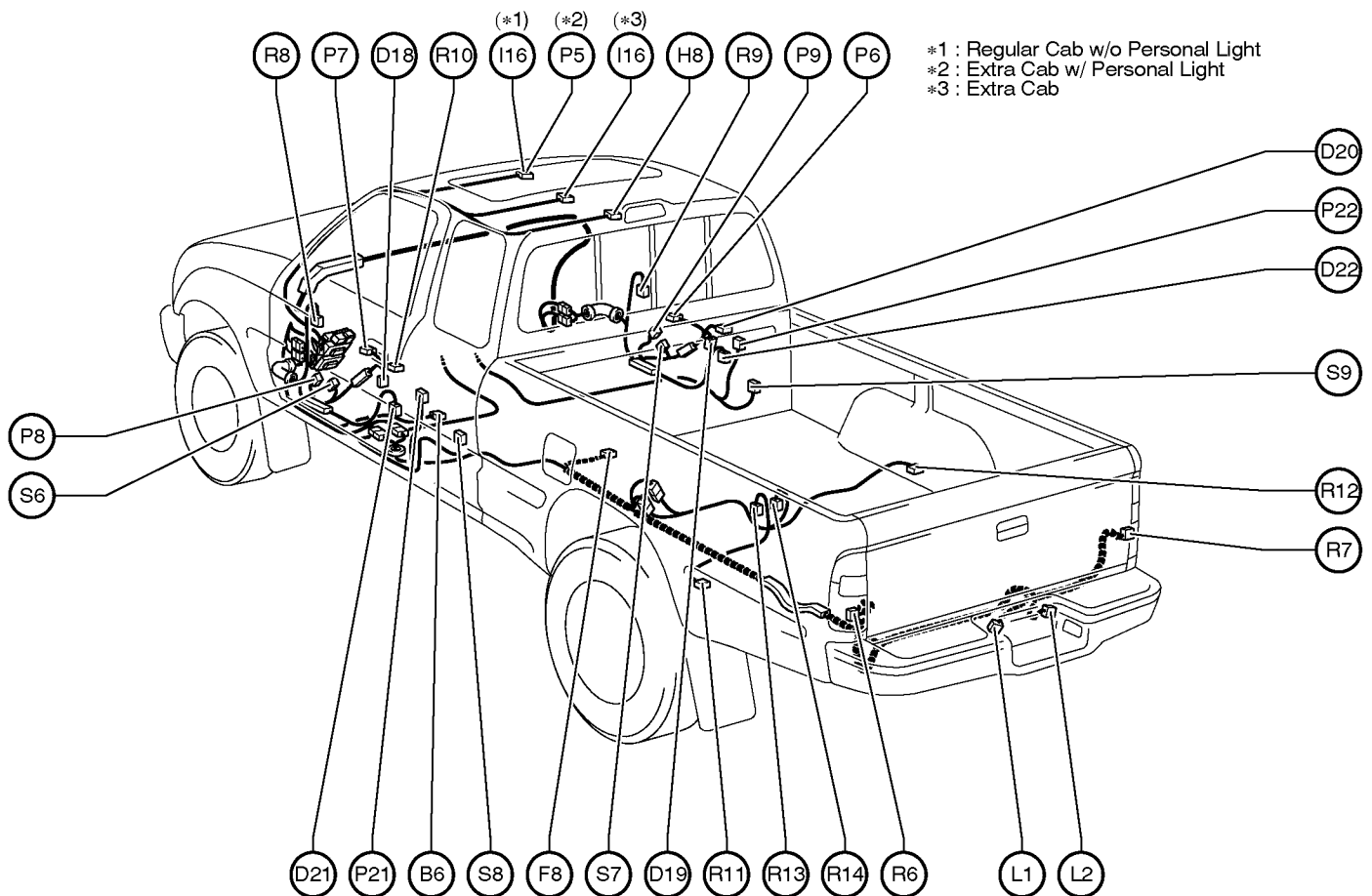

B 6 Buckle SW

D18 Door Courtesy Light LH

D19 Door Courtesy Light RH

D20 Door Lock Control SW RH

D21 Door Lock Motor,Door Unlock Detection SW and Door Key Lock and Unlock SW LH

D22 Door Lock Motor,Door Unlock Detection SW and Door Key Lock and Unlock SW RH

F 8 Fuel Pump and Sender

H 8 High Mounted Stop Light

I 16 Interior Light

L 1 License Plate Light LH

L 2 License Plate Light RH

P 5 Personal Light (*2)

P 6 Power Window Control SW RH

P 7 Power Window Master SW and Door Lock Control SW LH

P 8 Power Window Motor LH

P 9 Power Window Motor RH

P21 Pretensioner LH

P22 Pretensioner RH

R 6 Rear Combination Light LH

R 7 Rear Combination Light RH

R 8 Remote Control Mirror LH

R 9 Remote Control Mirror RH

R10 Remote Control Mirror SW

R11 Rear ABS Speed Sensor LH

R12 Rear ABS Speed Sensor RH

R13 Rear Diff. Lock Detection SW

R14 Rear Diff. Lock Motor

S 6 Speaker (Door LH)

S 7 Speaker (Door RH)

S 8 Speaker (Rear LH)

S 9 Speaker (Rear RH)

